

DATE PLOTTED: 20 December 2017 9:10 AM BY: NATHAN WHITE

TBM LOCATION TABLE					
TBM No.	LOCATION	EASTING	NORTHING	TYPE	RL (AHD)

**NOTE:**  
TBMS TO BE CONFIRMED BY SURVEYORS PRIOR TO CONSTRUCTION.  
FOR FURTHER DETAILS CONTACT TAYLORS PH: (03) 9501 2800

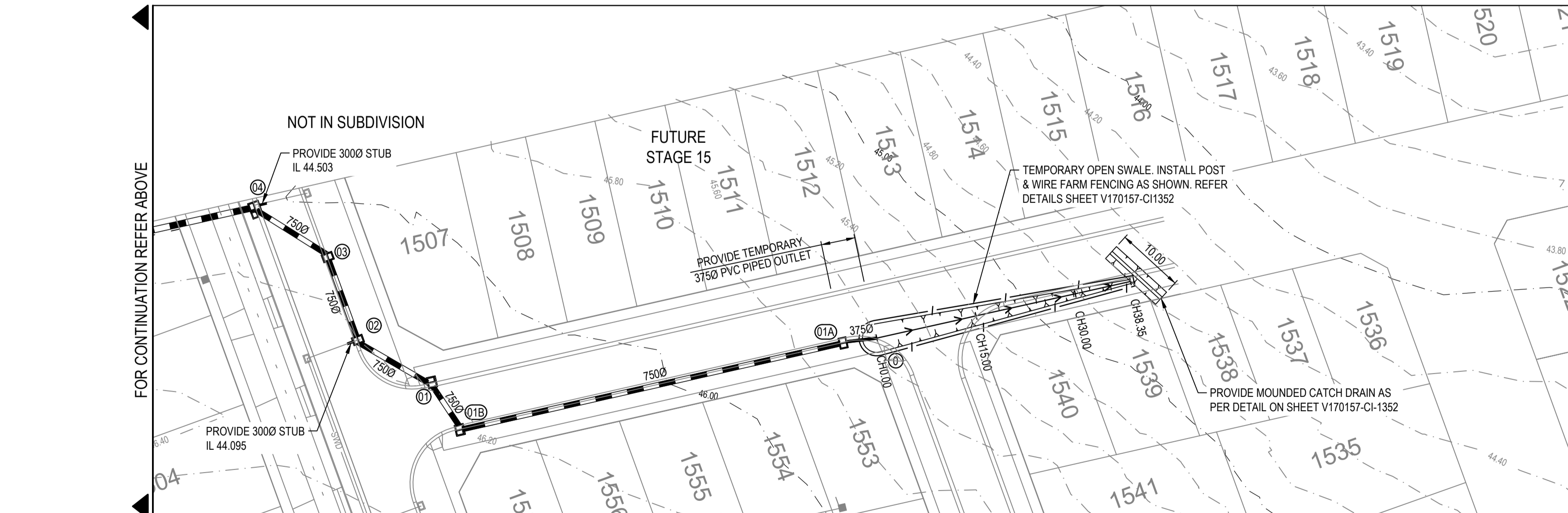
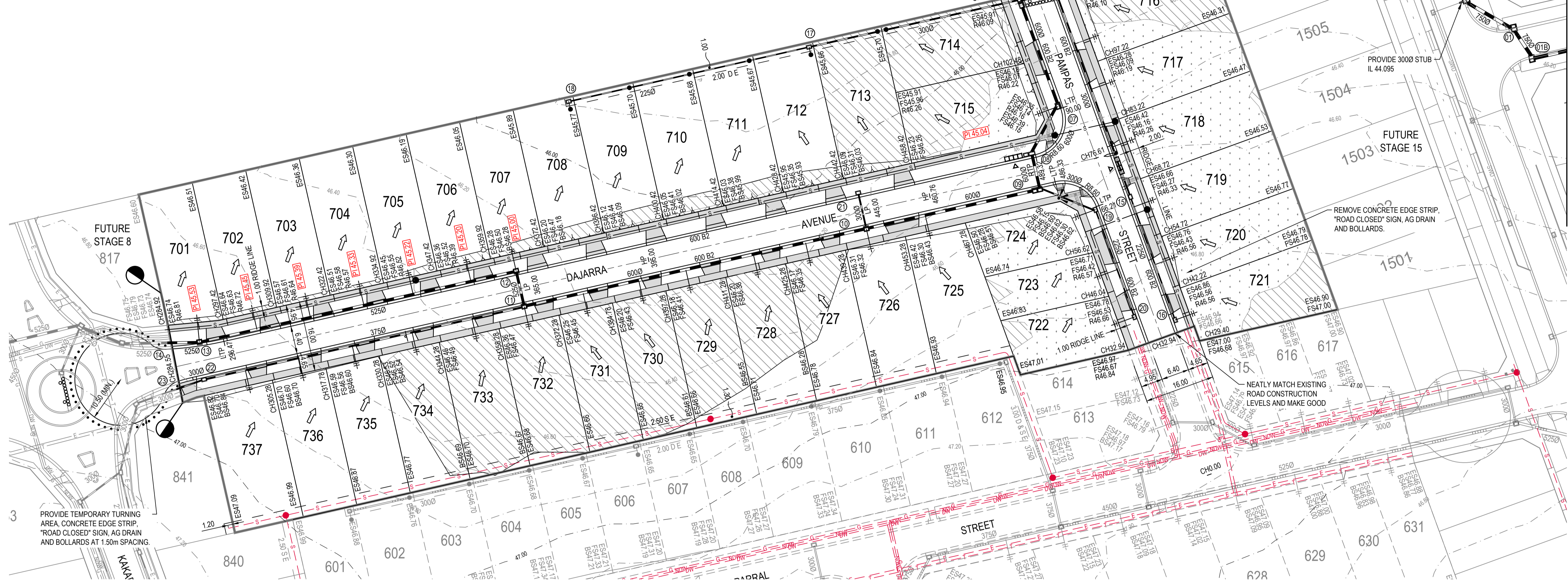

LEGEND	
	PERMANENT SURVEY MARK
	TEMPORARY BENCH MARK
	EXISTING SURFACE CONTOUR - MAJOR
	EXISTING SURFACE CONTOUR - MINOR
	FALL OF ALLOTMENT
	CENTRELINE OF ROAD
	ES100.00 EXISTING SURFACE LEVELS
	FS100.00 FINISHED SURFACE LEVELS
	BS100.00 BATTER SURFACE LEVELS
	R100.00 RIDGE LEVELS
	PI(100.00) PROPERTY INLET INVERT LEVEL
	KERB AND CHANNEL (AS SHOWN)
	PROPOSED RETAINING WALL
	VEHICLE EXCLUSION FENCE (BY OTHERS)
	PROPOSED ZERO LOT LINE
	STAGE BOUNDARY
	PROPOSED BATTER
	EXISTING TREE
	EXISTING TREE TO BE REMOVED
	EXISTING FEATURES TO BE REMOVED
	DIRECTIONAL HAZARD
	TACTILE GROUND SURFACE INDICATORS
	PROPOSED INDUSTRIAL VEHICLE CROSSING
	PROPOSED RESIDENTIAL VEHICLE CROSSING
	LIMIT OF WORKS
	"NO ROAD" SIGN AND BARRIER
	PROPOSED TRAFFIC SIGN
	PROPOSED STREET SIGN
	LINE-MARKING AND RRPMs
	PROPOSED STORMWATER DRAIN, PIT, DIAMETER AND PROPERTY INLET
	EXISTING STORMWATER DRAIN, PIT, DIAMETER AND PROPERTY INLET
	PROPOSED MAIN DRAIN, PIT AND DIAMETER
	EXISTING MAIN DRAIN, PIT AND DIAMETER
	AG PROPOSED AGRICULTURAL DRAIN
	PIT NUMBER
	PROPOSED SWALE DRAIN
	OFFSET FROM BUILDING LINE
	PROPOSED SEWER, MAINT. STRUCTURES
	EXISTING SEWER, MAINT. STRUCTURES
	PROPOSED RISING MAIN
	EXISTING RISING MAIN
	EXISTING WATER
	EXISTING GAS
	EXISTING ELECTRICITY
	EXISTING TELECOMMUNICATION
	EXISTING DRINKING WATER
	EXISTING NON-DRINKING WATER
	EXISTING WATER AND GAS CONDUIT
	1.5m RADIUS NO DIG ZONE AROUND EXISTING OVERHEAD ELECTRICAL POLES
	CONCRETE INFILL
	VEHICLE CROSSING AND FOOTPATH
	SHARED PATH
	LANDSCAPING (BY OTHERS)
	INTERSECTION TREATMENT (SEGMENTAL PAVERS)
	LOT GRADING (CUT)
	LOT GRADING (FILL LESS THAN 300mm DEEP)
	LOT GRADING (FILL GREATER THAN 300mm DEEP)
	TEMPORARY GARBAGE COLLECTION POINT FOR LOTS 714 TO 716 INCLUSIVE

**WARNING**  
HIGH PRESSURE GAS MAINS IN CLOSE PROXIMITY

**WARNING**  
BEWARE OF UNDERGROUND SERVICES  
THE LOCATION OF UNDERGROUND SERVICES ARE APPROXIMATE ONLY AND THEIR EXACT POSITION SHOULD BE PROVEN ON SITE. NO GUARANTEE IS GIVEN THAT ALL EXISTING SERVICES ARE SHOWN.

CONTRACTOR TO VERIFY EXISTING SERVICES CONNECTION LEVELS PRIOR TO CONSTRUCTION. ANY DISCREPANCIES MUST BE IMMEDIATELY IDENTIFIED AND THE SUPERINTENDENT NOTIFIED PRIOR TO CONSTRUCTION COMMENCING.

**COUNCIL REFERENCE**  
WYP7871/14.17

Rev.	Date	Description	Des.	Verif.	Appd.
D	11.12.2017	TEMPORARY DRAINAGE AMENDED	S.H.	S.C.	
C	09.11.2017	CONSTRUCTION ISSUE	S.H.	S.C.	
B	20.10.2017	COUNCIL COMMENTS	S.H.	S.C.	
A	28.09.2017	CONSTRUCTION ISSUE	S.H.	S.C.	

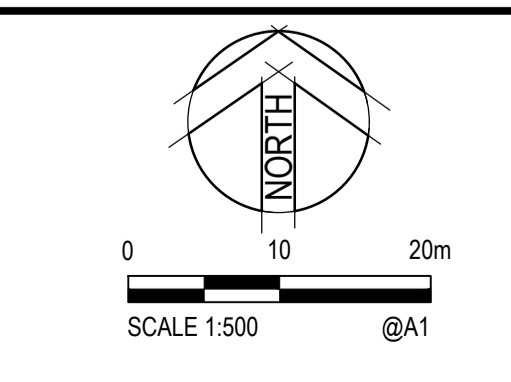

© Cardno Limited All Rights Reserved.  
This document is produced by Cardno Limited solely for the benefit of and use by the client in accordance with the terms of the retainer. Cardno Limited does not and shall not assume any responsibility or liability whatsoever to any third party arising out of any use or reliance by third party on the content of this document.



Drawn	Date	Client
A.F.	28.06.2017	HOBBS ROAD WYNDHAM TRUST
Checked	Date	Project
S.C.	17.08.2017	SAVANA - STAGE 7
Designed	Date	50 HOBBS ROAD, WYNDHAM VALE
S.H.	21.07.2017	WYNDHAM CITY COUNCIL
Verified	Date	Title
S. CUTAJAR	28.09.2017	CIVIL SITEWORKS
Approved	Date	DETAIL PLAN
N. GLASSON	20.12.2017	

Datum	Melways Ref	Scale	Size
AHD	233 H10	1:500	A1
Drawing Number	Revision		
V170157-CI-1050	D		

XREFs: XR-CG151016-CI-BASE; XR-V161886C-CI-BASE; XR-V170212-CI-BASE; XR-CG150545-CI-EX-CONTOURS; XR-V162288-CI-BASE; XR-V170157-CI-HATCH; XR-V170157-CI-FUTURE; XR-V170157-CI-TITLE; BLOCK; XR-V170157-TBMTABLE; XR-V170157-EWKS  
 CAD File: M:\2017\10001\_0500\170157\_Savana\_Silage\_7\Civil\Drawing\170157-CI-1050.dwg